

# FLUSH HEAD STUDS

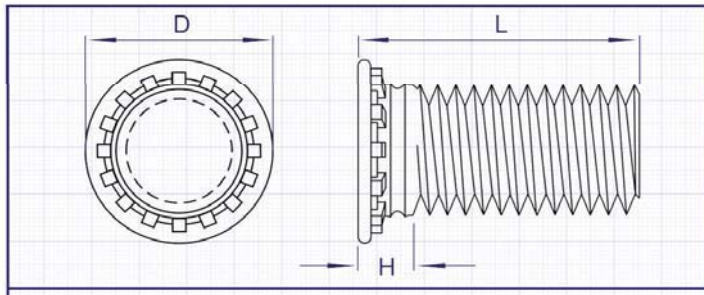

visit: [www.npfasteners.com/nfh.shtml](http://www.npfasteners.com/nfh.shtml)

## TYPE NFH

Also available with thread lead in Type NFHD



### SPECIFICATION

Thread & Pitch	D ±0.4	H Max.	Min. Rec. Sheet Thickness	Hole Size +0.08 -0.0	Max Mating Hole	Min C/L to Edge of Panel
M2.5 x 0.45	4.1	1.95	1.0	2.5	3.1	5.4
M3 x 0.5	4.6	2.1	1.0	3.0	3.6	5.6
M3.5 x 0.6	5.3	2.25	1.0	3.5	4.1	6.4
M4 x 0.7	5.9	2.4	1.0	4.0	4.6	7.2
M5 x 0.8	6.5	2.7	1.0	5.0	5.6	7.2
M6 x 1.0	8.2	3.0	1.6	6.0	6.6	7.9
M8 x 1.25	9.6	3.7	2.4	8.0	8.6	9.0

### STANDARD LENGTHS

Thread Size	'L' Length ±0.4											
M2.5	6	8	10	12	15	18	-	-	-	-	-	-
M3	6	8	10	12	15	18	20	25	30	-	-	-
M3.5	6	8	10	12	15	18	20	25	-	-	-	-
M4	6	8	10	12	15	18	20	25	30	-	-	-
M5	-	8	10	12	15	18	20	25	30	35	-	-
M6	-	-	10	12	15	18	20	25	30	35	-	-
M8	-	-	10	12	15	18	20	25	30	35	40	-

### INFORMATION

#### FINISHES

Bright Zinc Trivalent Clear Passivate (ZI), (Other Platings Available To Special Order).

#### MATERIALS

Carbon Steel, 300 Series Stainless Steel (A2), (400 Series Stainless Steel (400) To Special Order), (Aluminium (AL) To Special Order).

#### PART NUMBER EXAMPLES

Type / Thread / Length / Finish = NFH - M4 - 10 - ZI (Clinch Stud, M4, 10mm, Steel, BZP)

#### NOTES

The following installation panel material hardness limitations apply when installing Self Clinching Studs. Steel Clinch Studs: 80HRB Max, 300 series Stainless Steel Clinch Studs: 70HRB Max, 400 series Stainless Steel Clinch Studs: 92HRB Max (a special anvil is recommended for a proper installation, the maximum recommended panel thickness is 2.4mm – call our sales office for further information), Aluminium Clinch Studs 50HRB Max.